



## San Lorenzo Valley Water District Boulder Creek, California

## Civil and Structural Engineering



This 1.75- acre commercial development will provide the Water District with a centralized operations facility. Mesiti-Miller Engineering (MME) is providing civil and structural engineering design services for the Water District and is responsible for the preparation of site plans, grading, drainage, utility, and erosion control plans. Structural design services include foundation plans, framing, and roof plans for the conversion of an existing 8,000 square foot wood-framed office building, a new 8,000 square foot steel operations building, and a 1,500 square foot Board of Director's addition. MME is also providing structural engineering services for the evaluation of photovoltaic solar carport structures.

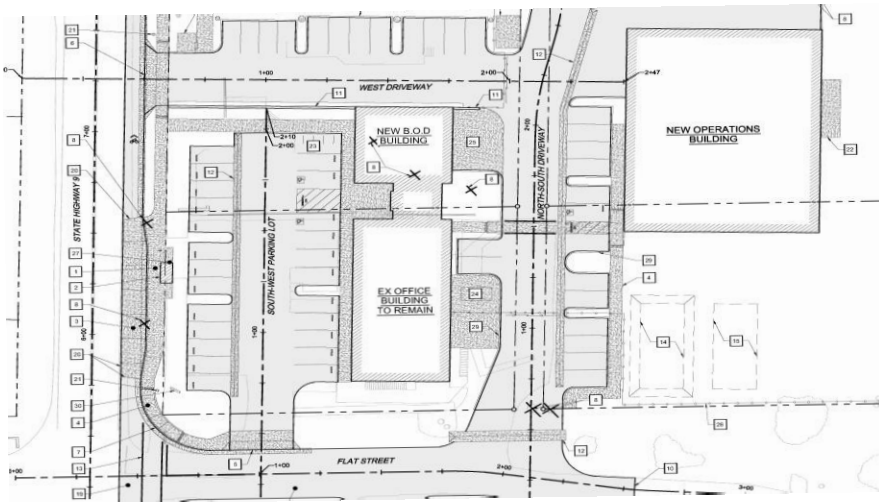

To assist the project in achieving LEED-certification, MME prepared drainage plans to limit the disruption of natural hydrology by reducing stormwater runoff rates and removing stormwater pollution and will prepare the Stormwater Pollution Prevention Plan (SWPPP) to prevent construction activity pollution. Low Impact Development (LID) design techniques incorporated into the design include vegetated bio-swales to treat parking area runoff, water quality treatment catch basins, a subsurface detention tank, and a hydrodynamic stormwater quality treatment device. This approach to stormwater management will capture and treat runoff from 90% of the average annual rainfall using acceptable Best Management Practices (BMPs).

### Client Reference:

Brian Lee, General Manager  
San Lorenzo Valley Water District  
13060 Highway 9  
Boulder Creek, CA 95006  
(831) 338-2153

**Budget:** \$5 million

